

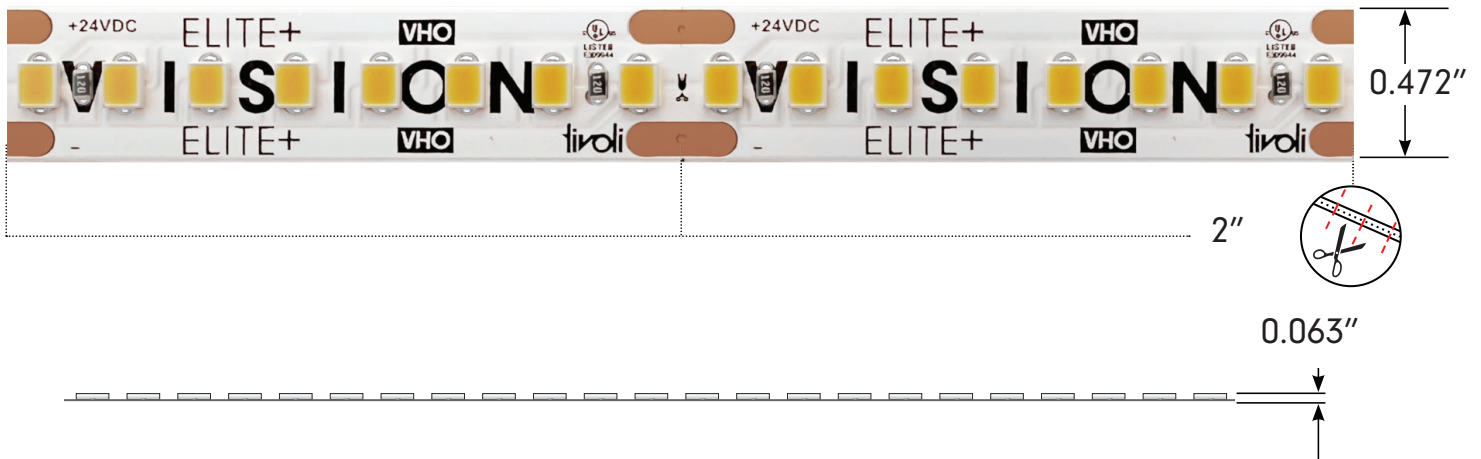

Project: _____ TYPE: _____

- Multiple intensities to choose from
- Low bin tolerance with a 1.5 Step McAdam Elipse standard
- High efficacy value
- Includes Tivoli's eXo shield coating
- Factory soldered lead wire
- Standard IP54 damp rated and IP67 wet location available
- Multiple mounting channel options
- Large range of available Kelvin temperatures
- Low lead times
- 4oz. Copper Trace
- 5 Year warranty

Dimensions





Order Guide

PRODUCT CODE	TYPE	INTENSITY	INSTALL	LED COLOR	VOLTAGE
TPLEP	VS		I		24
TPLEP = TivoTape ELITE Plus+	VS = Vision	SB = Standard Brightness HO = High Output VHO = Very High Output	I = Indoor	18 = 1800K 22 = 2200K 24 = 2400K 27 = 2700K 30 = 3000K 35 = 3500K 40 = 4000K 50 = 5000K	24 = 24V DC

Note: A layout/drawing must accompany each order showing run length and location
 Note: Runs with LEAD-C are rounded **up** to next cut interval (unless otherwise specified)
 Note: Runs with LEAD-D are rounded **down** to next cur interval (unless otherwise specified)

Specification

SB Standard Brightness								
Kelvin Temperature	1800K	2200K	2400K	2700K	3000K	3500K	4000K	5000K
Lumens/ft	273	348	358	371	429	399	407	412
Efficacy (Lm/W)	95	120	124	129	148	140	142	142
CRI	95	95	95	98	92	98	97	97
Measured Power W/ft	2.9	2.9	2.9	2.9	2.9	2.9	2.9	2.9
Listed Power W/ft.	3							
Max Run	30'							

HO High Output								
Kelvin Temperature	1800K	2200K	2400K	2700K	3000K	3500K	4000K	5000K
Lumens/ft	595	700	720	739	851	789	809	774
Efficacy (Lm/W)	96	113	116	121	139	131	139	133
CRI	95	95	95	98	98	98	97	97
Measured Power W/ft	6.2	6.2	6.2	6.1	6.1	6	5.8	5.8
Listed Power W/ft.	6							
Max Run	14'							

VHO Very High Output								
Kelvin Temperature	1800K	2200K	2400K	2700K	3000K	3500K	4000K	5000K
Lumens/ft	581	860	885	923	1061	1002	841	939
Efficacy (Lm/W)	89	132	136	142	163	154	141	156
CRI	95	95	95	95	93	93	97	97
Measured Power W/ft	6.5	6.5	6.5	6.5	6.5	6.5	6	6
Listed Power W/ft.	7							
Max Run	13'							

Electrical	
Input Voltage	24V
Dimming	MLV/ELV/0-10V/DMX
Physical	
LED Package	2835
LEDs/ft	48
Adhesive	3M VHB Tape
Copper Trace	4 Ounce
Dimensions	0.472" (12mm)
Cut Increments	2" (50.8mm)
Operating Temperature	-40°F (-40°C) ~ +140°F (+60°C)
Certification and Testing	
Certification	UL Listed, CE
Lumen Maintenance (L70)	60,000 hrs
Binning Tolerance	1.5 Step MacAdam Elipse
Environment	IP54 Damp Location, Conformal eXo Shield
Warranty	5 years

Power Leads and Jumpers (Installed by Tivoli's certified solderers)

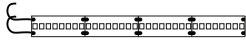

TPL-I-LEAD-2-C
LEAD/END
24" standard 2 conductor
18AWG lead wire factory
attached to one end of tape

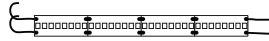

TPL-I-LEAD-2-D
LEAD/LEAD
24" standard 2 conductor
18AWG lead wire factory
attached to both ends of tape

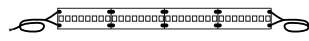

TPL-I-XEP-2
EXTRA LEAD WIRE
Additional factory attached
18AWG lead 2 wire to extend
lengths of LEAD-C and LEAD-D
up to 20 ft. max
Sold per foot

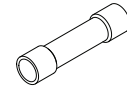

TPL-I-CONN
18-22AWG BUTT CONNECTORS
Used to interconnect factory
attached lead wires.
Sold individually.

Compatible Extrusions

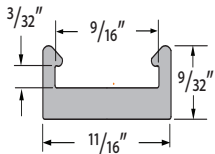

MCHAN-8-LP
Low profile NO LENS OPTION
clear polycarbonate, length 8'

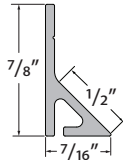

TPL-I-45-MCH-8-S
White PVC, 45° NO LENS
length 8'

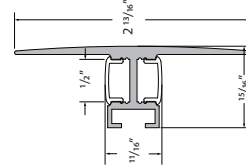

DWAR-CHAN-SLV-6.5
Anodized Aluminum Extrusion,
available in 6.5' lengths

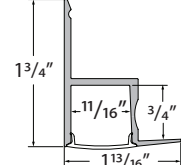

EDGE-CHAN-SLV-6.5
Anodized Aluminum Extrusion,
available in 6.5' lengths

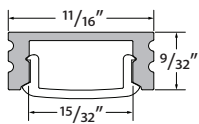

MINI-CHAN-SLV-6.5
Anodized Aluminum Extrusion,
available in 6.5' lengths

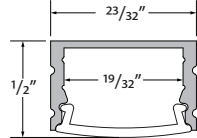

MOFT-CHAN-SLV-6.5
Anodized Aluminum Extrusion,
available in 6.5' lengths

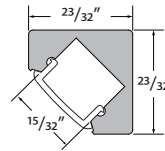

DYER-CHAN-SLV-6.5
Anodized Aluminum Extrusion,
available in 6.5' lengths

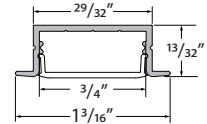

WRNR-CHAN-SLV-6.5
Anodized Aluminum Extrusion,
available in 6.5' lengths

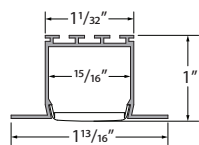

NOYS-CHAN-SLV-6.5
Anodized Aluminum Extrusion,
available in 6.5' lengths

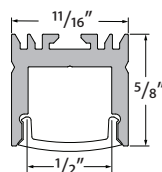

VALN-CHAN-SLV-6.5
Anodized Aluminum Extrusion,
available in 6.5' lengths

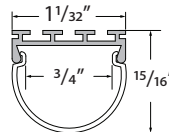

DOME-CHAN-SLV-6.5
Anodized Aluminum Extrusion,
available in 6.5' lengths

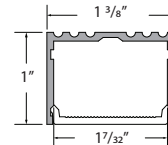

ALTN-CHAN-SLV-6.5
Anodized Aluminum Extrusion,
available in 6.5' lengths

Compatible Extrusions

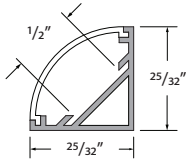

MRSI-CHAN-SLV-6.5
Anodized aluminum extrusion available in 6.5' length

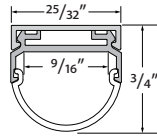

HRIZ-CHAN-SLV-6.5
Anodized aluminum extrusion available in 6.5' length

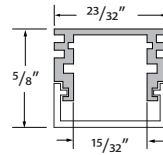

ASTR-CHAN-SLV-6.5
Anodized aluminum extrusion available in 6.5' length

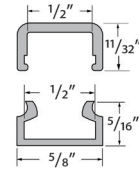

INF-X-CHAN-8
X = C (clear), F (frosted)
PC extrusion, available in 8' lengths

In-Wall Controls

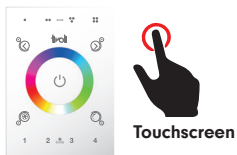

TVOQ-1-WH
White

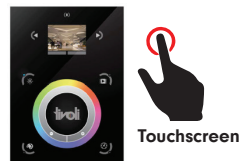

TVOQ-10-XX-7
XX = BK (Black), WH (White)



TVOQ-2-BK
Black

Power Supplies

INFINITY - MLV / ELV / 0-10V / PWM / TRIAC

DESCRIPTION	CAT NO	APPLICATION	PRIMARY VOLTAGE	SECONDARY VOLTAGE	CIRCUIT BREAKERS	MAX LOAD	MIN LOAD	CIRCUIT CAPACITY
Infinity Series Class 2 Transformer	INF-J-30-1-1.3-24	Indoor / Outdoor	100 - 277V AC	24V DC	1	30W	3W	1.3A
	INF-J-60-1-2.5-24				1	60W	6W	2.5A
	INF-J-96-1-4-24				1	96W	9W	4A
	INF-J-192-2-4-24				2	2x96W	2x9W	2x4A
	INF-J-288-3-4-24				3	3x96W	3x9W	3x4A

ER

DESCRIPTION	CAT NO	APPLICATION	PRIMARY VOLTAGE	SECONDARY VOLTAGE	CIRCUIT BREAKERS	MAX LOAD	CIRCUIT CAPACITY
ER Series Class 2	ER-80-1-3.3-24-D	Indoor / Outdoor	100-277V AC 50/60 Hz	24V DC	1	80W	3.3A
ER Series Class 2 0-10V Dimming	ERG-80-24-DIM1-10						

Recommended Power Supplies

ADUL/ADNM - NON DIMMING

DESCRIPTION	CAT NO	APPLICATION	PRIMARY VOLTAGE	SECONDARY VOLTAGE	CIRCUIT BREAKERS	MAX LOAD	CIRCUIT CAPACITY
ADUL/ADNM Series Class 2 Transformer	ADNM-90-1-4-24-D	Indoor / Outdoor	100-277V AC 50/60 HZ	24V DC	1	90W	3.75A
	ADUL-120-1-4-24-D				1	96W	4A
	ADUL-240-2-4-24-D				2	2x96W	2x4A
	ADUL-320-3-4-24-D				3	3x96W	3x4A

ADUL/ADNM - 0-10V DIMMING

DESCRIPTION	CAT NO	APPLICATION	PRIMARY VOLTAGE	SECONDARY VOLTAGE	CIRCUIT BREAKERS	MAX LOAD	CIRCUIT CAPACITY
ADUL/ADNM Series Class 2 Transformer	ADNM-90-1-4-24-DOT	Indoor / Outdoor	100-277V AC 50/60 HZ	24V DC	1	90W	3.75A
	ADUL-120-1-4-24-DOT				1	96W	4A
	ADUL-240-2-4-24-DOT				2	2x96W	2x4A
	ADUL-320-3-4-24-DOT				3	3x96W	3x4A

ADUL/ADNM - DMX SINGLE ADDRESS

DESCRIPTION	CAT NO	APPLICATION	PRIMARY VOLTAGE	SECONDARY VOLTAGE	CIRCUIT BREAKERS	MAX LOAD	CIRCUIT CAPACITY
ADUL/ADNM Series Class 2 Transformer	ADNM-90-1-4-24-DIN	Indoor / Outdoor	100-277V AC 50/60 Hz	24V DC	1	90W	3.75A
	ADUL-120-1-4-24-DIN				1	96W	4A
	ADUL-240-2-4-24-DIN				2	2x96W	2x4A
	ADUL-320-3-4-24-DIN				3	3x96W	3x4A

ADUL - DMX MULTI ADDRESS

DESCRIPTION	CAT NO	APPLICATION	PRIMARY VOLTAGE	SECONDARY VOLTAGE	CIRCUIT BREAKERS	MAX LOAD	CIRCUIT CAPACITY
ADUL Series Class 2 Transformer	ADUL-240-2-4-24-DIN-2	Indoor / Outdoor	100-277V AC 50/60 Hz	24V DC	2	2x96W	2x4A
	ADUL-320-3-4-24-DIN-3				3	3x96W	3x4A

ADNM - DMX/DALI FLICKER-FREE FOR TV STUDIO

DESCRIPTION	CAT NO	APPLICATION	PRIMARY VOLTAGE	SECONDARY VOLTAGE	CIRCUIT BREAKERS	MAX LOAD	CIRCUIT CAPACITY
ADNM Series Class 2 Transformer	ADNM-120-1-4-24-DTV	Indoor / Outdoor	100-277V AC 50/60 HZ	24V DC	1	1x96W	1x4A
	ADNM-240-2-4-24-DTV				2	2x96W	2x4A
	ADNM-320-3-4-24-DTV				3	3x96W	3x4A



Recommended Dimmers

DIMMING - 0-10V

DESCRIPTION	CAT NO	APPLICATION	INPUT VOLTAGE	OUTPUT VOLTAGE	MAX LOAD	PRICE
0-10V Dimmer	DIM-LD-010	Indoor	12V/24V DC	12V/24V DC	30 mA max. output (sink only)	\$ 120.00/ea

DIMMING -MLV

DESCRIPTION	CAT NO	APPLICATION	INPUT VOLTAGE	OUTPUT VOLTAGE	MAX LOAD
MLV Dimmer	N-600	Indoor	120V AC	120V AC	450W
	N-1000				800W
	N-1500				1200W
	D-600				450W
	M-600				450W
	M-1000				800W

DIMMING - ELV

DESCRIPTION	CAT NO	APPLICATION	INPUT VOLTAGE	OUTPUT VOLTAGE	MAX LOAD
ELV Dimmer	ME-600	Indoor	120V AC	120V AC	450W
	DE-300				300W